

Part Number	A	B	C	D	E	F	G
PSL-HD2.4	2.37 [60.2]	1.00 [25.40]	0.25 [6.35]	2.00 [50.80]	2.30 [58.42]	1.63 [41.40]	0.43 [10.92]

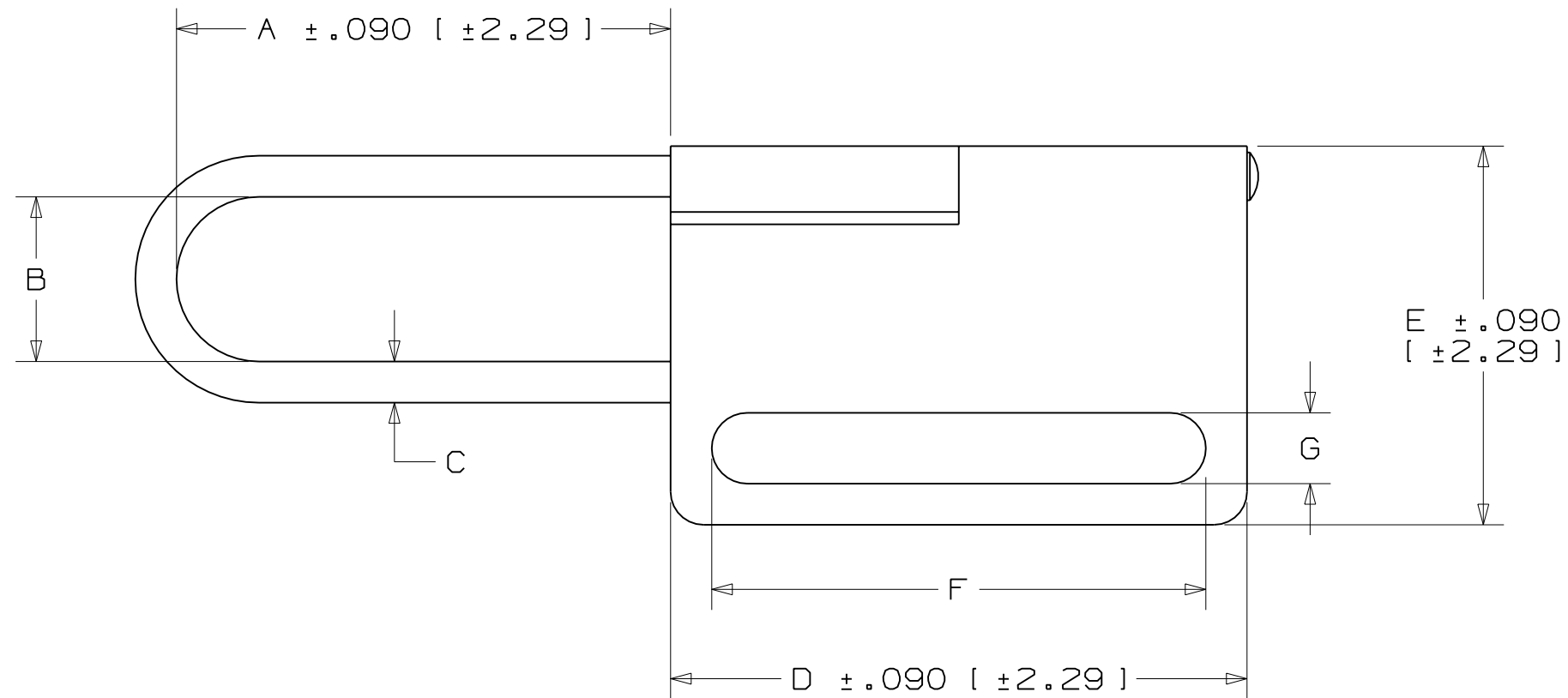

NOTES:
 1. DIMENSIONS IN [] ARE IN MILLIMETERS.
 2. O-RING TO BE OMITTED.

CAD FILENAME/LAYERS 100619BB_C10409_PSL-HD2.4_00.prt

PANDUIT CORP TINLEY PARK, ILLINOIS
 CUSTOMER DWG.
 PSL-HD2.4
 HEAVY DUTY HASP

UNLESS OTHERWISE SPECIFIED,
 DIMENSIONAL TOLERANCES ARE:
 (.X) ± (.XXX) ±
 (.XX) ± .06 [1.52] ANGLES ±

UNLESS OTHERWISE SPECIFIED,
 ALL DIMENSIONS ARE GIVEN IN
 INCHES, THIRD ANGLE PROJECTION

DRAWN BY
 RVU

MAT'L:

SCALE
 NTS

DATE
 5-2-06

BENT ROD.
 STAINLESS STEEL
 FLAT PLATE -
 ZINC PLATED STEEL

DRAWING NO.

C10409

DWG
 B
 SIZE

REV	DATE	BY	CHK	DESCRIPTION	ECN	R	CUST	SUP
0	5-2-06	RVU		DRAWING RELEASED.	4479	R		